

Segment ID	Segment Description					Length (miles)	Travel Lanes	Jurisdiction	Median	Speed Limit (mph)	FDOT Access Classification	FDOT Functional Classification	Typical Section	1999 AADT
	Roadway	From Mile Post	Roadway	To Mile Post										
A	Escambia River Bridge	0.000	CR 197A / Woodbine Rd.	3.033		3.03	4	Santa Rosa County	Grass Median	55	3	Urban Minor Arterial	Rural	35,000
B	CR 197A / Woodbine Rd.	3.033	CR 197 / Chumuckla Hwy.	4.026		0.99	4	Santa Rosa County	Grass Median	45	3	Urban Minor Arterial	Rural	35,000
C	CR 197 / Chumuckla Hwy.	4.026	Jernigan Rd.	4.585		0.56	4	Santa Rosa County	2-Way Left Turn Lane	40	6	Urban Minor Arterial	Urban with Sidewalks	35,000
D	Jernigan Rd.	4.585	CR 197B / W. Spencer Field Rd.	4.830		0.25	4	Santa Rosa County	Grass Median	40	5	Urban Minor Arterial	Rural	35,000
E	CR 197B / W. Spencer Field Rd.	4.830	CR 197A / School Ln.	7.078		2.25	4	Santa Rosa County	Grass Median	45	5	Urban Minor Arterial	Rural	28,000
F	CR 197A / School Ln.	7.078	SR 281 / Avalon Blvd.	9.317		2.24	4	Santa Rosa County	Grass Median	55	5	Urban Minor Arterial	Rural	24,000

**LEGEND**

- Traffic Signal
- Corridor Study Segment
- Match Line

0.0 0.25 0.5 1.0 mi

**Existing Corridor Characteristics**

**Figure 2 - 1**

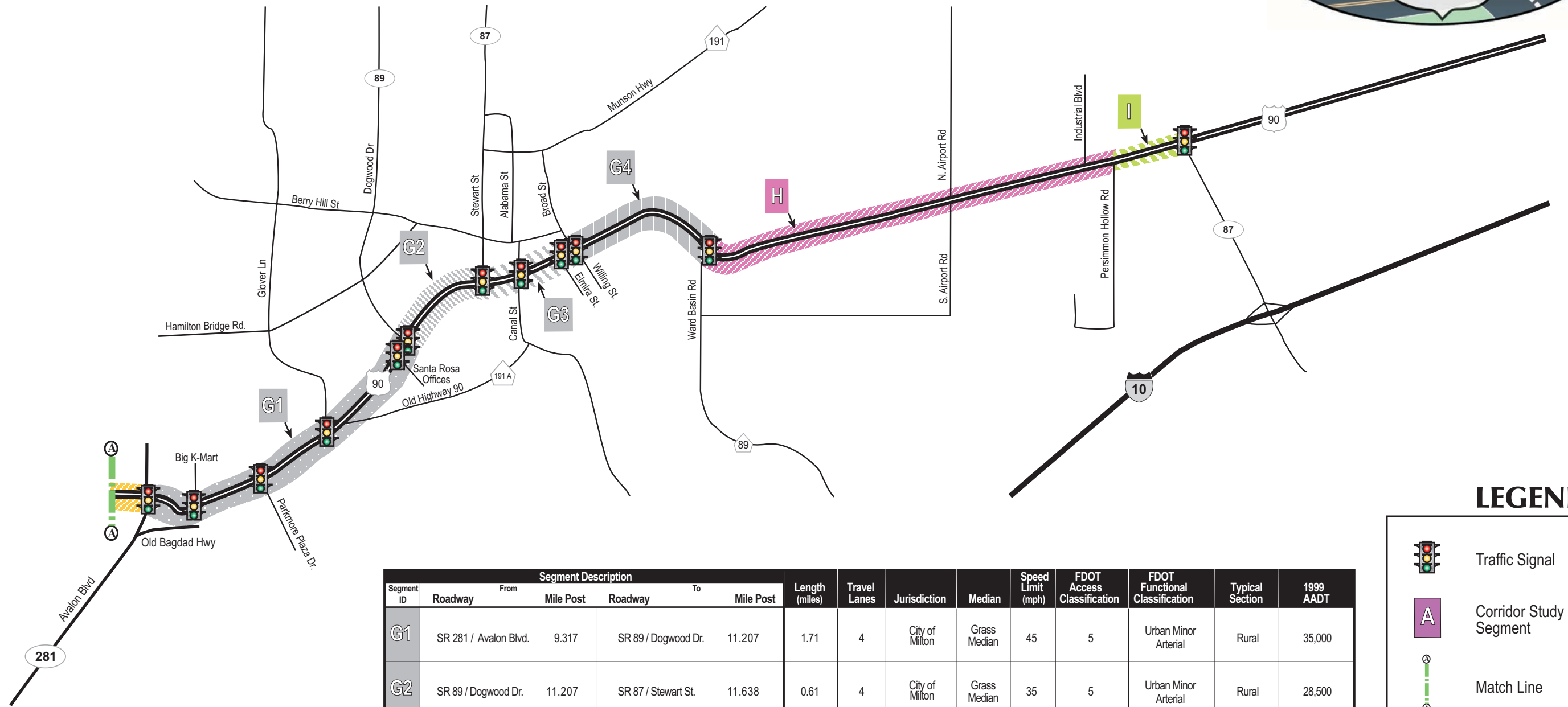

Segment Description													
Segment ID	Roadway	From Mile Post	Roadway	To Mile Post	Length (miles)	Travel Lanes	Jurisdiction	Median	Speed Limit (mph)	FDOT Access Classification	FDOT Functional Classification	Typical Section	1999 AADT
G1	SR 281 / Avalon Blvd.	9.317	SR 89 / Dogwood Dr.	11.207	1.71	4	City of Milton	Grass Median	45	5	Urban Minor Arterial	Rural	35,000
G2	SR 89 / Dogwood Dr.	11.207	SR 87 / Stewart St.	11.638	0.61	4	City of Milton	Grass Median	35	5	Urban Minor Arterial	Rural	28,500
G3	SR 87 / Stewart St.	11.638	Willing St.	12.128	0.49	2	City of Milton	None	25	5	Urban Minor Arterial	Urban with Sidewalk	16,000
G4	Willing St.	12.128	CR 89 / Ward Basin Rd.	13.219	1.09	2	Santa Rosa County	None	40	6	Urban Minor Arterial	Rural	16,500
H	CR 89 / Ward Basin Rd.	13.219	Persimmon Hollow Rd.	15.773	2.55	2	Santa Rosa County	None	55	4	Urban Minor Arterial	Rural	10,900
I	Persimmon Hollow Rd.	15.773	SR 87	16.227	0.45	2	Santa Rosa County	None	55	4	Rural Minor Arterial	Rural	8,500

**LEGEND**

- Traffic Signal
- Corridor Study Segment
- Match Line



**Existing Corridor Characteristics**

**Figure 2 - 1 con't**



Segment ID	Segment Description				Length (miles)	Travel Lanes	Jurisdiction	Median	Speed Limit (mph)	FDOT Access Classification	FDOT Functional Classification	Typical Section	1999 AADT
	Roadway	From Mile Post	Roadway	To Mile Post									
G1	SR 281 / Avalon Blvd.	9.3170	SR 89 / Dogwood Dr.	11.207	1.71	4	City of Milton	Grass Median	45	5	Urban Minor Arterial	Rural	35,000
G2	SR 89 / Dogwood Dr.	11.207	SR 87 / Steward St.	11.638	0.61	4	City of Milton	Grass Median	35	5	Urban Minor Arterial	Rural	28,500
G3	SR 87 / Steward St.	11.638	Willing St.	12.128	0.49	2	City of Milton	None	25	6	Urban Minor Arterial	Urban with Sidewalk	16,000
G4	Willing St.	12.128	CR 89 / Ward Basin Rd.	13.219	1.09	2	Santa Rosa County	None	40	6	Urban Minor Arterial	Rural	16,500
H	CR 89 / Ward Basin Rd.	13.219	Persimmon Hollow Rd.	15.773	2.55	2	Santa Rosa County	None	55	4	Urban Minor Arterial	Rural	10,900
I	Persimmon Hollow Rd.	15.773	SR 87	16.227	0.45	2	Santa Rosa County	None	55	4	Rural Minor Arterial	Rural	8,500